



## Clutch Pedal and Support

### Removal

1. Disconnect clutch and starter interlock harness from switch.
2. Disconnect master cylinder push rod from clutch pedal. Rotate master cylinder 45 degrees counterclockwise to release it from dash panel. It is not necessary to remove master cylinder from vehicle.
3. Remove pedal support retaining nuts at dash panel.
4. Remove bolt attaching pedal support to cowl. Remove pedal and support from vehicle.
5. To remove pedal from support, remove clutch and starter switch as outlined. Remove nut attaching clutch pedal to support.

### Installation

1. If removed, install clutch pedal to support. Tighten retaining nut to 20-27 N-m (15-19 lb-ft). Be sure pedal bushings are in place.
2. Install clutch and starter switch, if removed, as outlined.
3. Position pedal assembly in vehicle. Loosely attach bolt through support in cowl.
4. Install three pedal assembly retaining nuts to dash panel. Tighten to 21-30 N-m (16-22 lb-ft).
5. Tighten cowl retaining bolt to 21-30 N-m (16-22 lb-ft).
6. Install master cylinder to dash panel by rotating 45 degrees clockwise into locking position.
7. Attach master cylinder push rod to clutch pedal.
8. Connect wiring harness to clutch/starter switch.

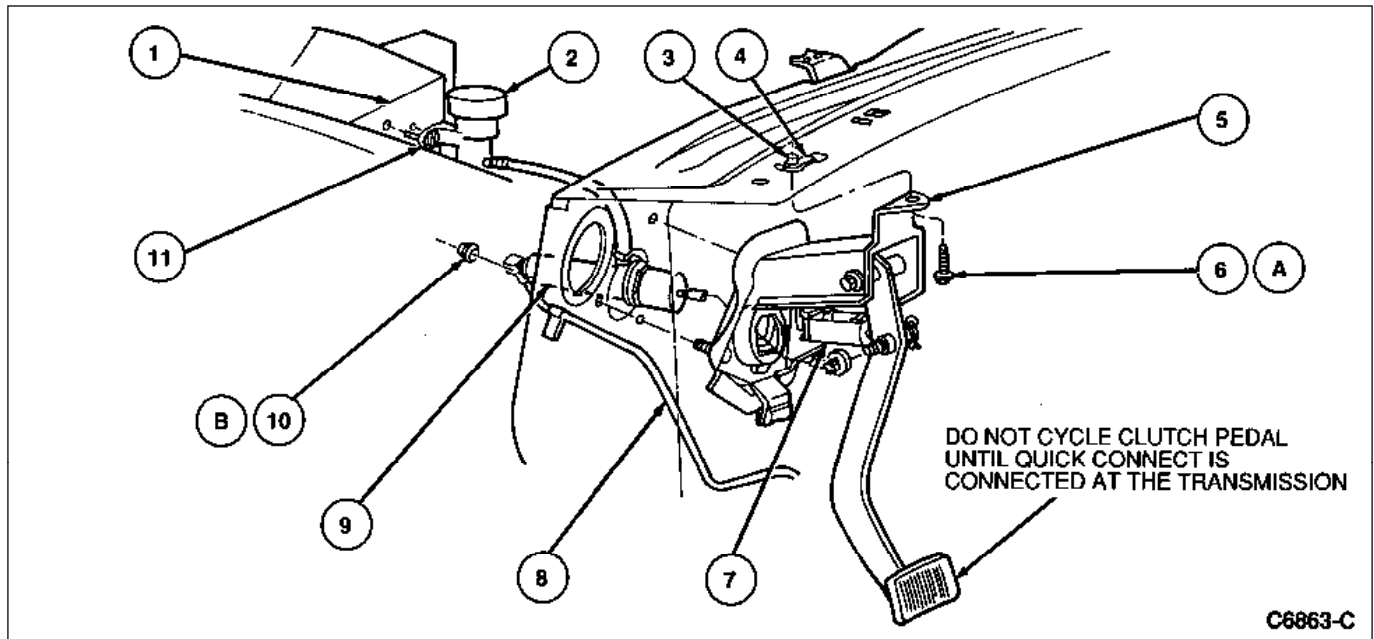

C6863-C

Item	Part Number	Description
1	-	LH Shock Tower
2	7C522	Reservoir
3	N800296-S2	J-Nut
4	-	Cowl
5	7B633	Pedal Bracket Assy
6A	N801921-S309	Bolt
7	11A152	Clutch/Starter Switch
8	7C522	Clutch Hydraulic Line Assy
9	7C522	Clutch Master Cylinder Assy
10B	N620481-S2	Nut
11	7C522	Push Pins
A		Tighten to 21-30 N-m (16-22 Lb-Ft)
B		Tighten to 16-30 N-m (12-22 Lb-Ft)