



Subassemblies

Shift Control Housing Assembly

Disassembly

1. If necessary, remove three M6 Torx® head screws from the shift control housing assembly using a T25 Torx® socket.

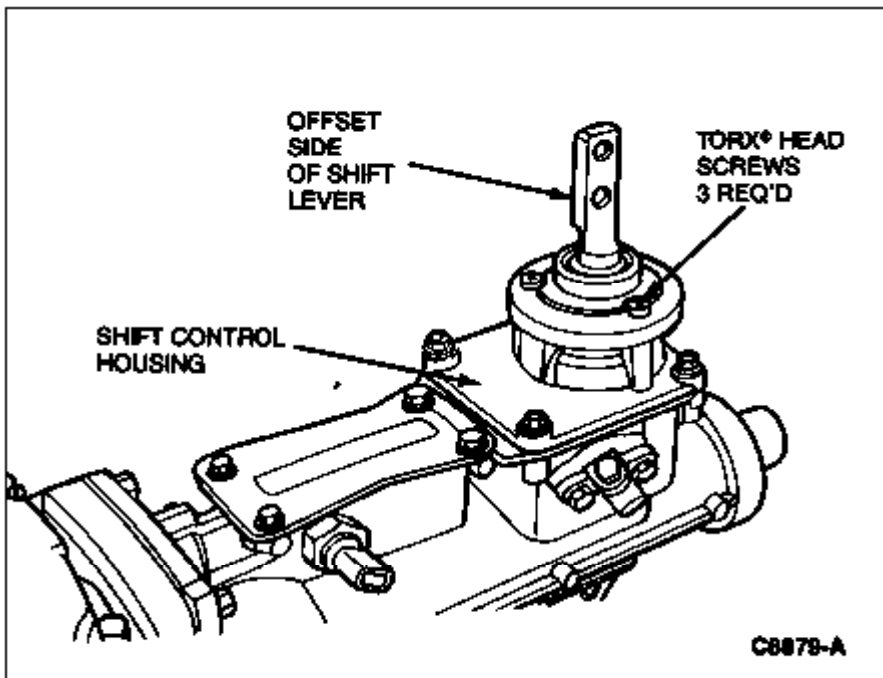

2. Lift shift lever assembly off shift control housing.

NOTE:

Offset side of shift lever, flat side of lower boot assembly, shift lever plate and gasket assembly are located on the passenger side of the vehicle.

3. Remove lower boot assembly, shift lever plate, gasket assembly, and spring, shim and bushing from lever and replace as necessary.

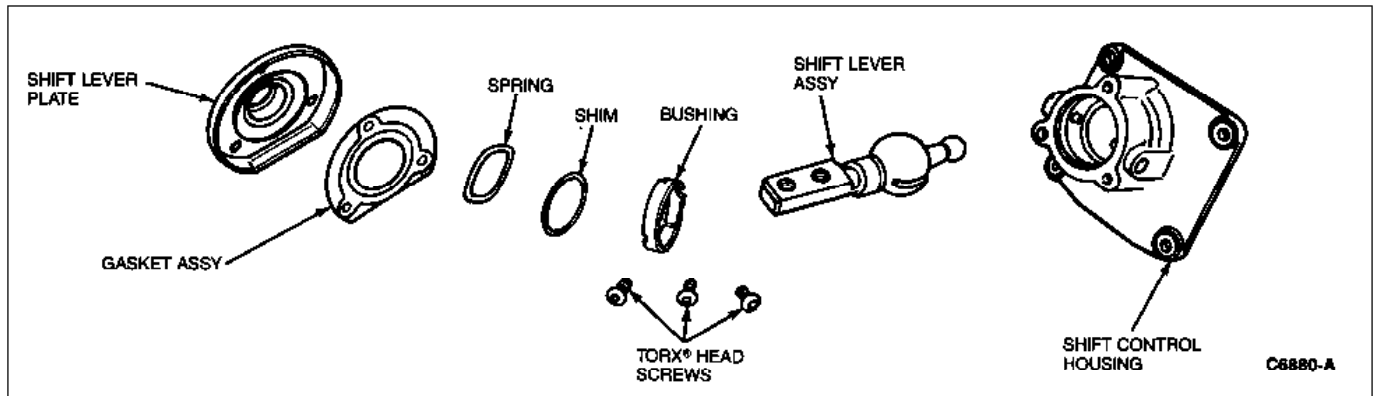

Assembly

NOTE:

Apply a light coating of Multi-Purpose Grease DOAZ-19584-AA (ESR-M1C159-A and ESB-M1C93-A) or equivalent to the shift lever ball and shift control housing socket prior to assembly.

1. Place shift lever in shift control housing. Be sure that offset side of lever is located on the RH side of vehicle.
2. Place bushing, shim, and spring assembly in shift control housing, making sure to seat bottom slots of bushing into tabs of control housing.
3. Clean mating surface of the shift lever plate and retain new gasket to plate with a small quantity of Synthetic MERCON® Multi-Purpose Automatic Transmission Fluid E6AZ-19582-B (ESR-M2C163-A2) or equivalent.
4. Align flat side of lower boot assembly and shift lever plate to RH side of vehicle and place over lever onto shift control housing.
5. Insert three M6 Torx® head screws through lower boot assembly shift lever plate into shift control housing. Using a T25 Torx® head socket, tighten screws to 7.8-10.7 N-m (6-8 lb-ft).
6. Clean all old sealant from shift control housing and replace with a 1/16 inch bead of Silicone Rubber D6AZ-19562-BA (ESB-M4G92-A) or equivalent.
7. Install shift control housing assembly onto extension housing. Using a 10mm socket, tighten four bolts to 7.8-10.7 N-m (6-8 lb-ft).

